



# Installation and Operation Manual



## JandyColors® Digital Color Blending, Underwater Pool and Spa Lights

### **WARNING**

**FOR YOUR SAFETY - This product must be installed and serviced by a professional pool/spa service technician. The procedures in this manual must be followed exactly. Failure to follow warning notices and instructions may result in property damage, serious injury, or death.**



## Table of Contents

Section 1. Safety Information .....	4
Section 2. Product Description and Model Numbers .....	5
Section 3. Installing Jandy Light Fixture during New Construction .....	6
3.1 Preparing the Light Fixture for Installation .....	6
3.2 Installing the Light Fixture .....	7
Section 4. Replacing Jandy Light Fixture in an Existing Pool or Spa .....	9
4.1 Preparing the Light Fixture for Replacement .....	9
4.2 Replacing the Light Fixture .....	9
Section 5. Wiring Options for Controlling Jandy Pool Lights or Jandy Spa Lights .....	11
5.1 Wiring to an AquaLink® RS Control System .....	11
5.2 Wiring to a Time Clock .....	12
Section 6. Jandy Pool Light and Jandy Spa Light Operating Instructions.....	13
6.1 To Operate the Light .....	13
6.2 To Lock On a Specific Color Set .....	13
6.3 To Initiate a New Cycle or Reset from a Locked Color.....	13
Section 7. Replacing Bulbs .....	14
Section 8. Twelve (12) Volt Installation .....	17
Section 9. Exploded View and Replacement Parts .....	18
9.1 Jandy Digital Pool Light .....	18
9.2 Jandy Digital Spa Light .....	19

## Section 1. Safety Information

### IMPORTANT SAFETY INSTRUCTIONS PERTAINING TO A RISK OF FIRE, ELECTRIC SHOCK, OR INJURY TO PERSONS

#### READ AND FOLLOW ALL INSTRUCTIONS

When installing and using this electrical equipment, basic safety precautions should always be followed, including the following:

#### WARNING

**RISK OF ELECTRICAL SHOCK OR ELECTROCUTION.** This underwater light must be installed by a licensed or certified electrician in accordance with the National Electrical Code and applicable local codes and ordinances. Improper installation will create an electrical hazard, which could result in death or serious injury to pool or spa users, installers, or others due to electrical shock, and may also cause damage to property. Read and follow the specific instructions below.

#### WARNING

Before installing this underwater light, read and follow all warning notices and instructions accompanying this light. Failure to follow safety warnings and instructions can result in severe injury, death, or property damage. Call (707) 776-8200 for additional free copies of these instructions.



**ATTENTION INSTALLER:** This manual contains important information about the installation, operation and safe use of this product. This information should be given to the owner/operator of this equipment.

#### NOTICE

These lights are intended for installation in fresh water swimming pools and spas only.

## SAVE THESE INSTRUCTIONS

## Section 2. Product Description and Model Numbers

<u>Product</u>	<u>Voltage</u>	<u>Cord Length</u>	<u>Model #</u>
Jandy Pool Light	12 Volt AC	30 feet	JPL1230
Jandy Pool Light	12 Volt AC	50 feet	JPL1250
Jandy Pool Light	12 Volt AC	100 feet	JPL12100
Jandy Pool Light	120 Volt AC	30 feet	JPL12030
Jandy Pool Light	120 Volt AC	50 feet	JPL12050
Jandy Pool Light	120 Volt AC	100 feet	JPL120100
Jandy Pool Light	120 Volt AC	150 feet	JPL120150
Jandy Spa Light	12 Volt AC	30 feet	JSL1230
Jandy Spa Light	12 Volt AC	50 feet	JSL1250
Jandy Spa Light	12 Volt AC	100 feet	JSL 12100
Jandy Spa Light	120 Volt AC	30 feet	JSL12030
Jandy Spa Light	120 Volt AC	50 feet	JSL12050
Jandy Spa Light	120 Volt AC	100 feet	JSL120100
Jandy Spa Light	120 Volt AC	150 feet	JSL120150

## Section 3. Installing Jandy Light Fixture during New Construction

### 3.1 Preparing the Light Fixture for Installation

**NOTE** The electrician must complete preparatory steps before light fixture is installed; see Figure 1 (or Figure 2, for spa).

1. Ensure that the pool or spa meets the requirements of the current National Electrical Code and all local codes and ordinances. A licensed or certified electrician must install the electrical system to meet or exceed those requirements before the underwater light is installed. Some of the requirements of the National Electrical Code, which the pool or spa's electrical systems must meet, are as follows:
  - a. The lighting circuit must have a Ground Fault Circuit Interrupter (GFCI) for line voltage 120 volt models, and must have an appropriately rated circuit breaker.
  - b. The Junction Box (or, for 12 volt models, the low voltage transformer) must be located at least eight (8) inches above water level, at least four (4) inches above ground level, and at least four (4) feet from the edge of the pool or spa; see Figure 1 for pools and Figure 2 for spas.
  - c. The light fixture and all metal items within five (5) feet of the pool or spa must be properly electrically bonded to a reliable point of grounding.
  - d. The wet niche must be properly installed so that the top edge of the underwater light's lens is at least 18 inches below the surface of the water in the pool or spa; see Figure 1 or 2. (Not more than 48 inch depth in Canada.)
  - e. The wet niche must be properly electrically bonded and grounded via the No. 8 AWG ground connector located at the rear of the niche; see Figure 1 or 2.

**NOTE** The pool or spa electrical system can be verified with a Pool and Spa Electrical Qualification Test kit. The test kit is available from local distribution. The electrical system inspection using this kit must be performed by trained and certified personnel.

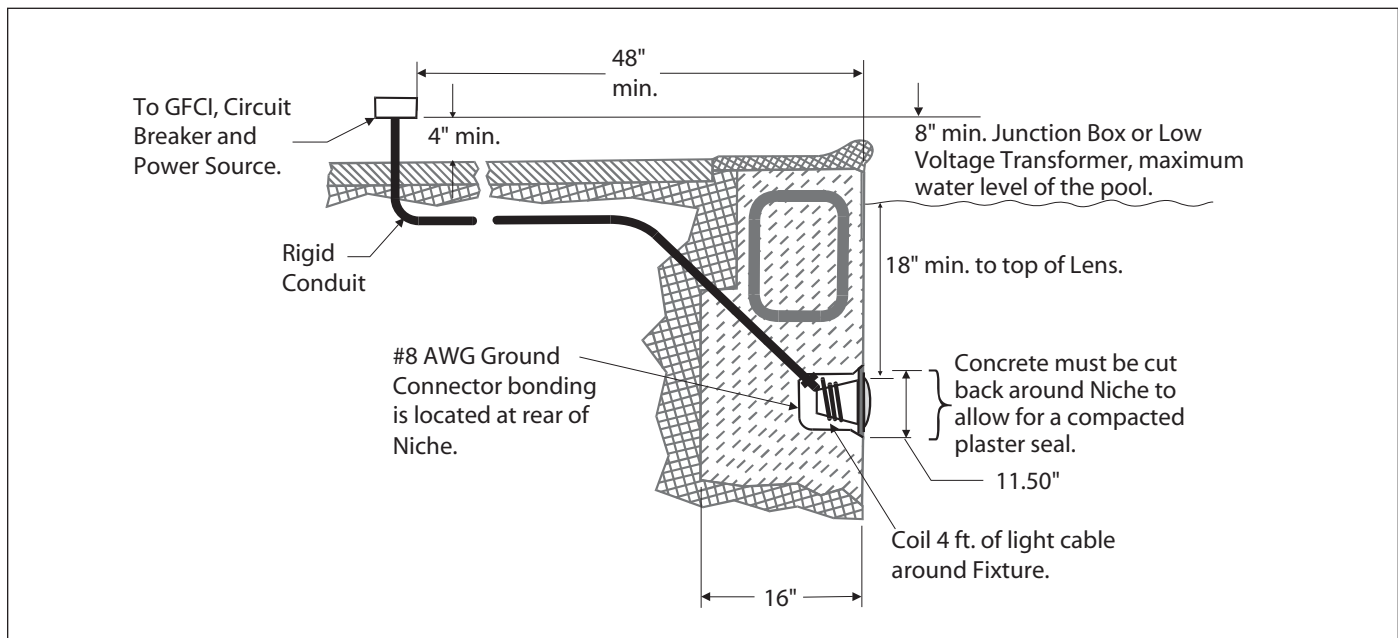
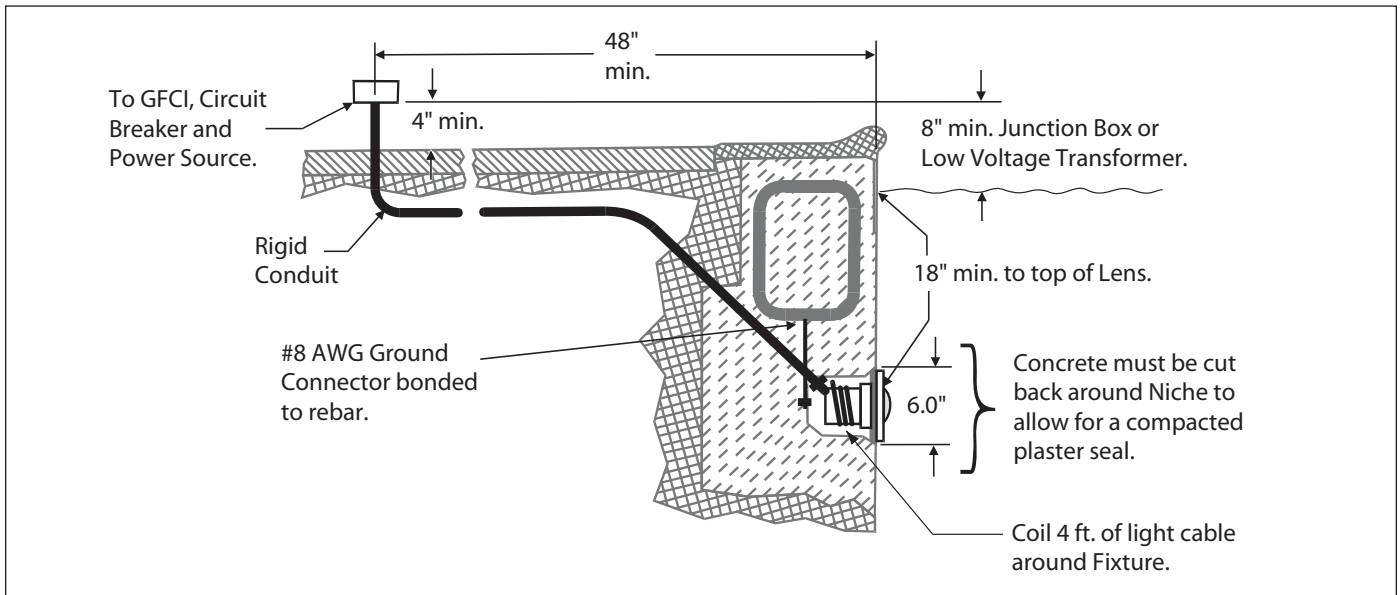

Figure 1. Jandy Digital Pool Light



**Figure 2. Jandy Digital Spa Light**

2. To be certain that the pool or spa’s electrical system meets all applicable requirements, the electrician should also consult the local building department.
3. Use only approved wet niches (see following note) to ensure a safe and proper installation.

**NOTE** Jandy Pool and Spa Lights are ETL listed (ETL report/file 3033587.001) for installation with *only* the following manufacturer’s wet niche fixtures:

**Large / Pool Type Niche Model Numbers:**

Pentair: 7821XXXX, 7822XXXX, 7823XXXX, 792067XX, 792089XX  
 Hayward DuraNiche: SP0600U  
 Sta-Rite: 05161-XXXX, 05163-XXXX

**Small / Spa Type Niche Model Numbers:**

Pentair: 7824XXXX, 792066XX  
 Hayward DuraNiche: SP0601U  
 Sta-Rite: 05166-XXXX, 05167-XXXX

**3.2 Installing the Light Fixture**

**NOTE** Perform these steps *only* after the electrical system requirements are met.

1. Feed cord through conduit to Junction Box, leaving at least four (4) feet of cord at the light fixture to coil around the light; see Figure 1 (or Figure 2, for spa). This four (4) feet of cord around the light allows the light to be serviced after the pool or spa is filled with water.
2. Cut the cord at the Junction Box, leaving at least six (6) inches of cord to make connections.
3. Strip six (6) inches of the outer cord jacket to expose the three insulated wires. *Be careful not to damage the insulation on the three (3) inner wires.*
4. Install strain relief over cord jacket and connect all three (3) wires to the corresponding circuit wires in the Junction Box. Install the Junction Box cover.

**⚠ WARNING**

Never operate this underwater light for more than 10 seconds unless it is totally submerged in water. Without total submersion, the light assembly will get extremely hot, which may result in serious burns or in breakage of the bulb or lens. This may result in serious injury to pool or spa users, installers, or bystanders or in damage to property.

5. Coil the 4-foot length of cord around the fixture and place the light assembly into the niche.
6. Engage the retainer tab on the bottom of the face ring, then pivot the top of the fixture inward and tighten the special pilot screw.

 **WARNING**

Use only the special pilot screw provided with this underwater light. This screw mounts and electrically grounds the housing securely to the mounting ring and wet niche. Failure to use the screw provided could create an electrical hazard, which could result in death or serious injury to pool or spa users, installers or others due to electrical shock.

7. Fill the pool or spa until the underwater light is completely submerged in water before operating the light for more than 10 seconds. Turn on main switch or circuit breaker, and the switch, which operates the underwater light, to check for proper operation. Refer to *Section 6, Operating Instructions*.



## Section 4. Replacing Jandy Light Fixture in an *Existing* Pool or Spa

### WARNING

**Risk of Electrical Shock or Electrocution.** This underwater light must be installed by a licensed or certified electrician or a qualified pool or spa serviceman in accordance with the National Electrical Code and all applicable local codes and ordinances. Improper installation will create an electrical hazard, which could result in death or serious injury to pool or spa users, installers or others due to electrical shock, and may also cause damage to property.

Always disconnect the power to the pool or spa light at the circuit breaker before servicing the light. Failure to do so could result in death or serious injury to serviceman, pool or spa users or others due to electrical shock.

### 4.1 Preparing the Light Fixture for Replacement

1. Verify that the pool or spa meets the requirements of the current National Electrical Code and all local codes and ordinances. A licensed or certified electrician must install the electrical system to meet or exceed those requirements before the underwater light is installed. Some of the requirements of the National Electrical Code, which the pool or spa's electrical system must meet, are as follows:
  - a. The lighting circuit must have a Ground Fault Circuit Interrupter (GFCI) for line voltage 120 volt models, and must have an appropriately rated circuit breaker.
  - b. The Junction Box (or, for 12 volt models, the low voltage transformer) must be located at least 8 inches above ground or water level, at least four (4) inches above ground level, and at least 48 inches from the edge of the pool or spa; see Figure 1 (or Figure 2, for spa).
  - c. The light fixture and all metal items within 5 feet of the pool or spa must be properly electrically bonded to a reliable point of grounding.
  - d. The wet niche must be properly installed so that the top edge of the underwater light's lens is at least 18 inches below the surface of the water in the pool or spa; see Figure 1 (or Figure 2, for spa).
  - e. The wet niche must be properly electrically bonded and grounded via the No. 8 AWG ground connector located at the rear of the niche; see Figure 1 (or Figure 2, for spa).

**NOTE** The pool or spa electrical system can be verified with a Pool and Spa Electrical Qualification Test Kit. The test kit is available from local distribution. The electrical system inspection using this kit must be performed by trained and certified personnel.

2. To be certain that the pool or spa's electrical system meets all applicable requirements, the electrician should also consult the local building department.
3. Use Jandy wet niches to ensure proper bonding and grounding connections.

### 4.2 Replacing the Light Fixture

**NOTE** Perform these steps *only* after the electrical system requirements are met.

### WARNING

Failure to bring the pool or spa's electrical system up to code requirements before installing the underwater light will create an electrical hazard which could result in death or serious injury to pool or spa users, installers, or others due to electrical shock, and may also cause damage to property.

**NOTE** The light fixture may be replaced without removing water from the pool or spa.

1. Turn off the **main** electrical switch or circuit breaker, as well as the switch, which operates the underwater light.
2. To remove the light assembly, remove the special pilot screw at top of the face ring, remove the light assembly from the niche, and place the assembly on the deck.

 **WARNING**

Be sure to keep the special pilot screw from this underwater light. This screw mounts and electrically grounds the housing securely to the mounting ring and wet niche. Failure to use the screw provided could create an electrical hazard, which could result in death or serious injury to pool or spa users, installers or others due to electrical shock.

3. Remove Junction Box cover, disconnect the light fixture wires and strain relief, and then pull the cord out of the conduit from the niche.
4. Feed the new light fixture cord through the conduit from the niche to the Junction Box.

**NOTE** Depending on the length of the conduit, special tools may be required to pull the cord through the conduit.

5. Leave at least 4 feet of cord to coil around the light fixture; see Figure 1 (or Figure 2, for spa). This allows the light to be serviced after the pool or spa is filled with water.
6. Cut the cord at the Junction Box, leaving at least 6 inches of cord to make connections.
7. Strip 6 inches of the outer cord jacket from the cord to expose the three insulated wires. Be careful not to damage the insulation on the three inner wires.
8. Install the strain relief over the cord jacket and connect all three wires to the corresponding circuit wires in the Junction Box, black wire to power, white wire to common, and green wire to ground. Install the Junction Box cover.
9. Replace light assembly into the niche and tighten the special pilot screw.

 **WARNING**

Use only the special pilot screw provided with this underwater light. This screw mounts and electrically grounds the housing securely to the mounting ring and wet niche. Failure to use the screw provided could create an electrical hazard, which could result in death or serious injury to pool or spa users, installers or others due to electrical shock.

10. Fill the pool or spa until the underwater light is completely submerged in water before operating the light for more than 10 seconds. Turn on main switch or circuit breaker, as well as the switch, which operates the underwater light, to check for proper operation. Refer to *Section 6, Operating Instructions*.

 **WARNING**

Never operate this underwater light for more than 10 seconds unless it is totally submerged in water. Without total submersion, the light assembly will get extremely hot, which may result in serious burns or in breakage of the bulb or lens. This may result in serious injury to pool or spa users, installers, or bystanders or in damage to property.

## Section 5. Wiring Options for Controlling Jandy Pool Lights or Jandy Spa Lights

**NOTE** The **Jandy Pool and Spa Lights** will not operate properly with light dimmers. *Do not wire the Jandy Lights to any dimming circuitry.*

To the extent allowed by code and capacity of the electrical equipment, multiple **Jandy Pool and Spa Lights** may be controlled with a single switch so their colors will *always* be synchronized.

Separate switches may be used to control the on/off and color functions of each **Jandy Pool or Spa Light**. It is recommended that these switches be located next to each other to facilitate simple color synchronization when desired. All switches *must be operated at the same time to assure color synchronization* otherwise the lights will work independently of each other.

### 5.1 Wiring to an AquaLink® RS Control System

The **Jandy Pool and Spa Lights** can be wired into the Jandy AquaLink RS control system to ensure simplified operation of the lights, as well as a means to synchronize the color change function. Connect the lights to one of the auxiliary relays in the Power Center.

**NOTE** It is recommended to connect one light per relay so each light can be controlled separately. However, up to four lights can be connected on a single relay. If there are more than four lights installed on one AquaLink RS system, ensure there is more than one auxiliary relay available in the Power Center.

Refer to Figures 3 and 4 to connect the **Jandy Pool and Spa Lights** to the Power Center.

**⚠ CAUTION**

A Ground Fault Circuit Interrupter (GFCI) *must* be provided in this circuit. The conductors on the load side of the GFCI circuit shall not occupy conduit, boxes, or enclosures containing other conductors unless the additional conductors are also protected by a GFCI. Refer to local codes for complete details.

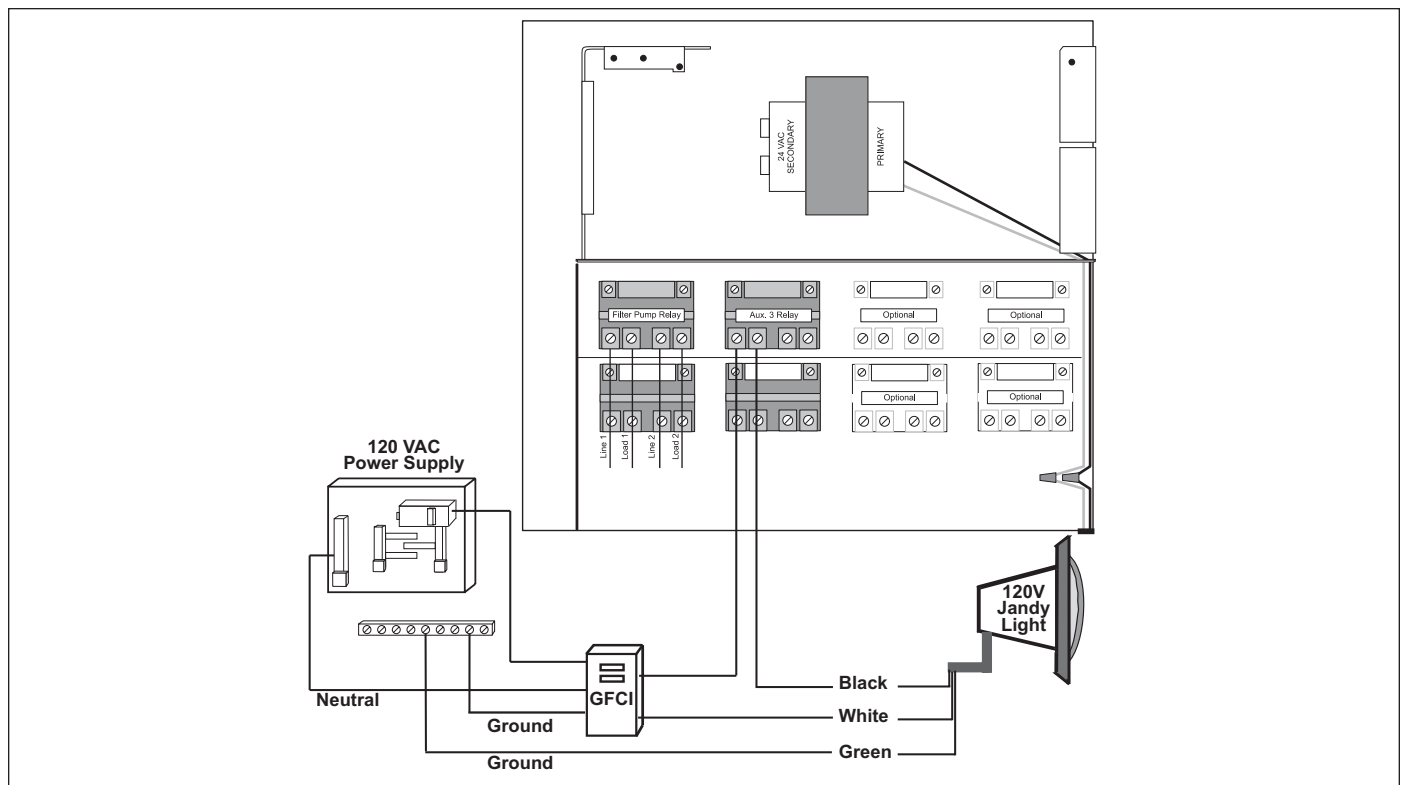

Figure 3. 120-Volt Jandy Pool and Spa Light Wiring Diagram

**NOTE** The **Jandy Pool and Spa Lights** are available in 120-volt and 12-volt versions. If installing a 12-volt light, a 120-volt/12-volt step-down (AC) transformer *must* be used. For more information about 12-volt installations, refer to *Section 8* of this manual.

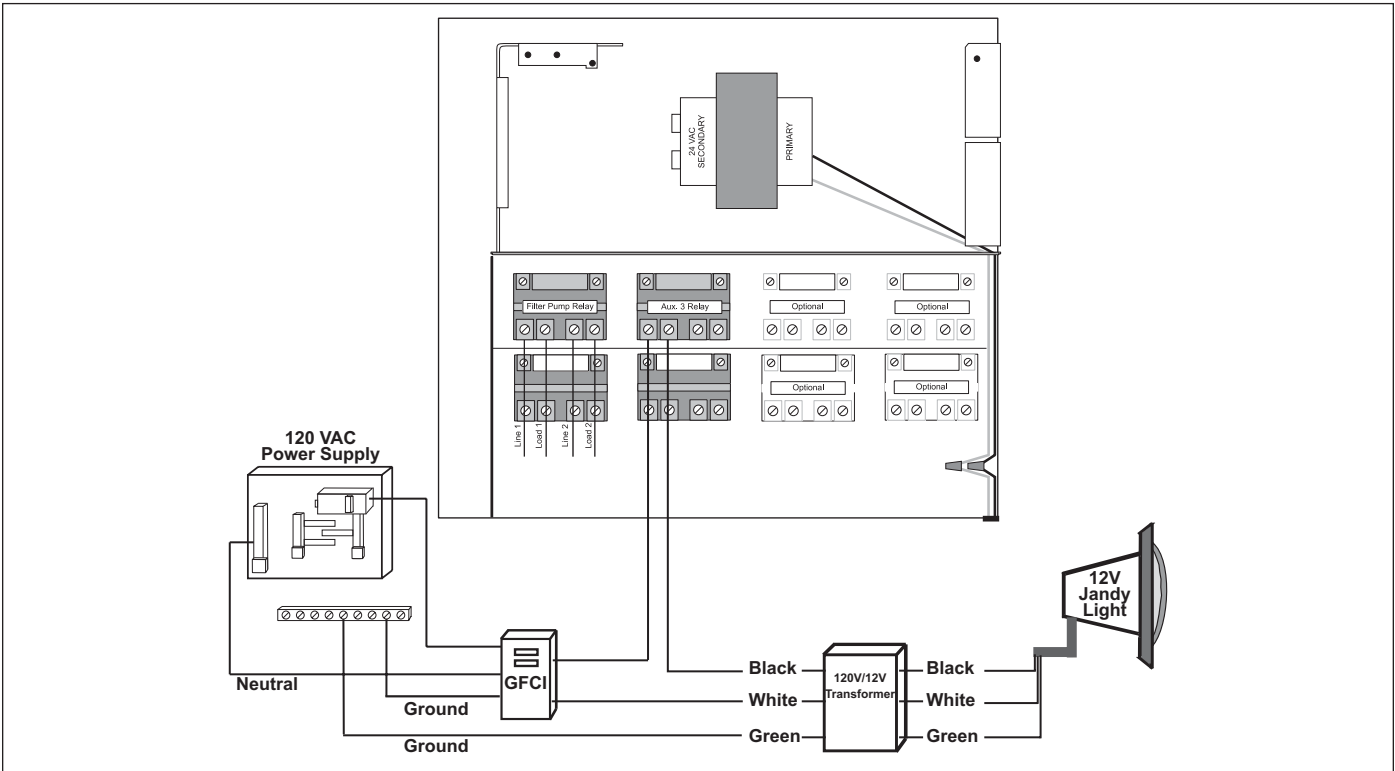

Figure 4. 12-Volt Jandy Pool and Spa Light Wiring Diagram

### 5.2 Wiring to a Time Clock

The **Jandy Pool and Spa Lights** can be wired into a basic time clock to automatically turn on the lights at a predesignated time. Refer to Figure 5 to connect the lights into the clock.

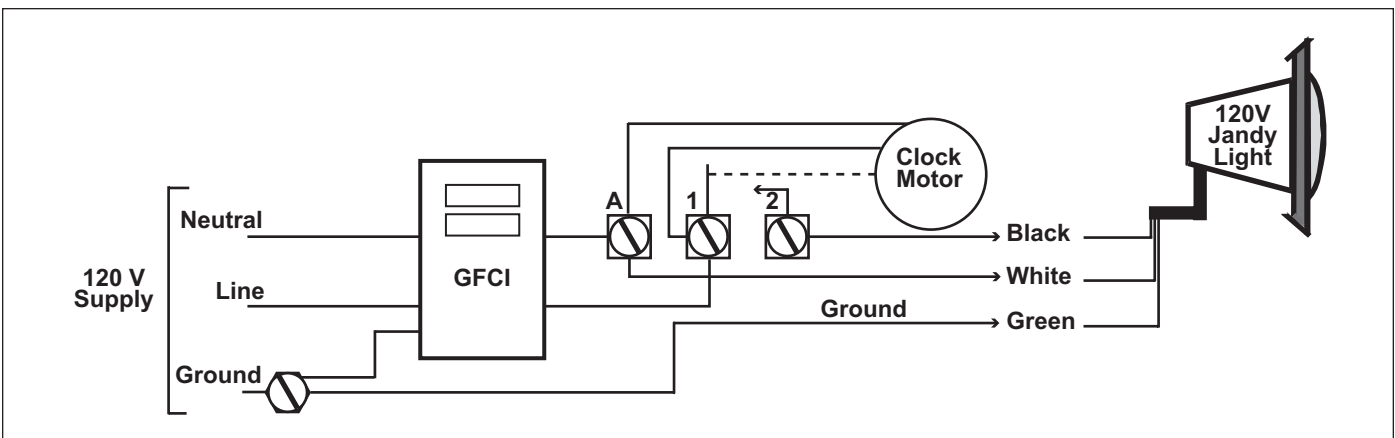

Figure 5. Wiring the Jandy Pool and Spa Light to a Time Clock

## Section 6. Jandy Pool Light and Jandy Spa Light Operating Instructions

### 6.1 To Operate the Light

Turn the light **ON**. The *first* time the light is turned on, the color change sequence begins with the Alpine White color set and then continues through the sequence. The light cycles through 10 color set changes. Each color set is active for approximately 20 seconds before the light transitions to the next color (see Table 1).

**Table 1. Pool and Spa Lights Color Change Sequence**

Sequence Order	Color Set (Consists of Two Colors in Each Light)
1	Alpine White (first cycle only)
2	Sky Blue
3	Cobalt Blue
4	Caribbean Blue
5	Spring Green
6	Emerald Green
7	Emerald Rose
8	Magenta
9	Garnet Red
10	Violet (color remains active approximately 4 minutes)

**NOTE** When the light is first turned on, the sequence ends at Violet and at the next rotation, starts at Sky Blue. Alpine White is not included in subsequent cycles.

When the light is turned off, it will remain in the color set that is currently active. When the light is turned back on, the color change sequence will start with the color set that was last active. For example, if the light is turned off when Cobalt Blue color set is active, then Cobalt Blue will be the first color set in the change sequence when the light is turned on again.

### 6.2 To Lock On a Specific Color Set

Wait until the desired color is **ON** during the *first cycle of color change*. Turn the light **OFF**, wait 2 seconds and then turn the light back **ON**. Wait 10 seconds before turning the light off so that the color will not reset.

**NOTE** If a specific color is not locked on during first cycle of colors, the light will continue to follow the color change sequence. To choose a color *after* the first cycle, the light must be reset.

If you encounter a dimmed light, the light was probably turned off during in the middle of the color transition. To resolve this situation, turn the light off for 3 seconds, then turn it back on. The light will return to full power.

### 6.3 To Initiate a New Cycle or Reset from a Locked Color

Turn the light **OFF**, wait 2 seconds, then turn **ON**, wait 2 seconds, then turn **OFF**, wait 2 seconds, and then turn **ON** again. The light will return to beginning of the color cycle (Alpine White) and continue with the normal light sequence (see Table 1 in Section 6.1).

**NOTE** To synchronize colors on multiple **Jandy Pool and Spa Light** systems wired to separate switches, perform the above actions on all of their switches simultaneously. All **Jandy Digital Pool and Spa Lights** will synchronize automatically if activated off of the same switch. No other accessories are required.

## Section 7. Replacing Bulbs

### WARNING

Always disconnect power to the pool or spa light at the circuit breaker before servicing the light. Failure to do so could result in death or serious injury to installer, serviceman, pool or spa users or others due to electrical shock.

1. Turn off the main electrical switch or circuit breaker, as well as the switch, which operates the underwater light.
2. Be sure to have the following items:
  - **A new lens gasket (P/N R0399800 for Jandy Pool Light and P/N R0400500 for Jandy Spa Light).**
  - Eight (8) new bulbs. See Table 2 for bulb specification.

### WARNING

Replace all bulbs with bulbs of the same type and wattage. Failure to replace the bulbs with those of the same type will damage the light assembly and may cause an electrical hazard resulting in death or serious injury to pool or spa users, installers, or others due to electrical shock, and may also cause damage to property. Be sure the power is switched OFF before removing or installing bulbs. Allow bulbs to cool before replacing. This light fixture uses quartz halogen bulbs. Hold bulbs on the outside only. DO NOT touch the bulb or surface with bare hands; doing so could severely reduce bulb life.

**Table 2. Bulb Specifications**

Model Number	Fixture Voltage	Bulb Voltage	Bulb Wattage	Halogen Bulb Type	Qty. per Fixture	Bulb Kit Part Number (2 bulbs per kit)
<b>JANDY POOL LIGHT</b>	120 Volt AC	12 Volt	75 Watt	MR-16 EYC	8	R0399600
<b>JANDY POOL LIGHT</b>	12 Volt AC	12 Volt	75 Watt	MR-16 EYC	8	R0399600
<b>JANDY SPA LIGHT</b>	120 Volt AC	12 Volt	25 Watt	Capsule (G-4)	8	R0400300
<b>JANDY SPA LIGHT</b>	12 Volt AC	12 Volt	25 Watt	Capsule (G-4)	8	R0400300

**NOTE** Both 120V and 12V **Jandy Pool and Spa Lights** use 12V Halogen bulbs.

3. To remove the light assembly, remove the special pilot screw at the top of the face ring, remove light assembly from niche and gently place assembly on the deck. It is not necessary to drain down the pool or spa (see Figure 6).

### WARNING

Be sure to keep the special pilot screw from this underwater light. This screw mounts and electrically grounds the housing securely to the mounting ring and wet niche. Failure to use the screw provided could create an electrical hazard, which could result in death or serious injury to pool or spa users, installers or others due to electrical shock.

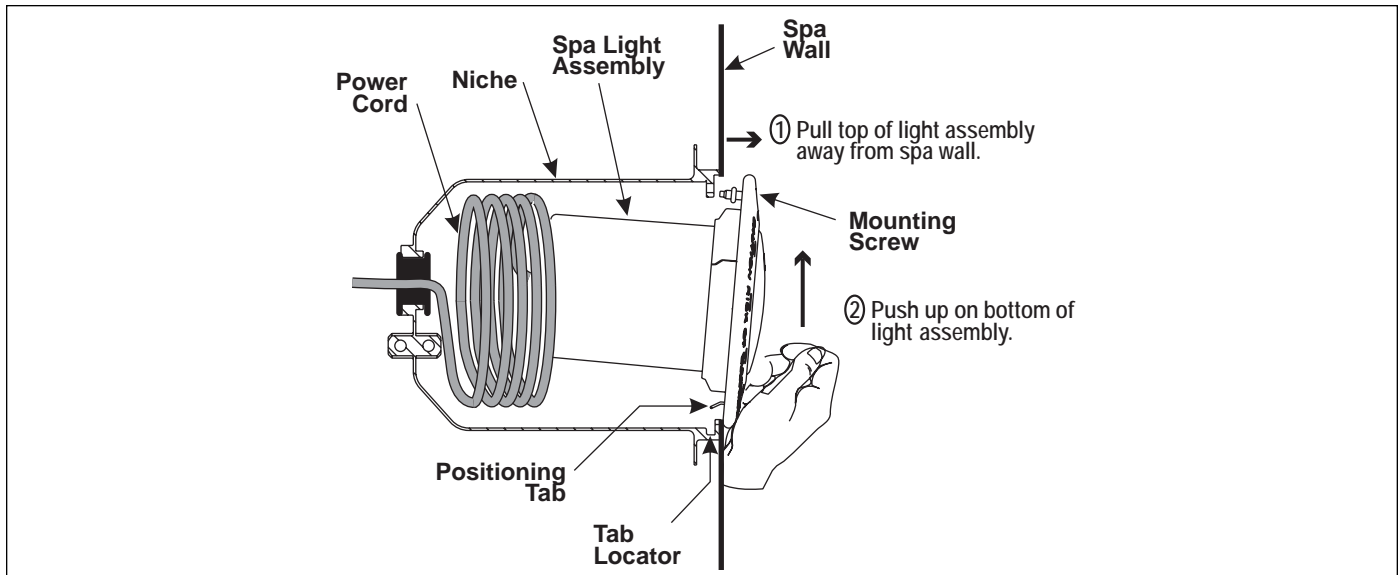

**Figure 6. Removing the Light Assembly for Bulb Replacement**

4. Disassemble the light fixture and replace bulbs. Use the following bulb removal instructions for Jandy Pool and Spa Light:

For Pool Light removal do Steps a and b, and for Spa Light removal do Steps c and d. Then continue with Step e.

- a. Unscrew eight (8) Phillips head screws on the bezel clamp assembly to allow the bottom clamp to be removed. Do not remove the screws or the retaining rings. The retaining rings prevent the screws from falling out and aid in ease of assembly.
- b. Remove the lower clamp, bezel face ring including the upper clamp, glass lens and gasket from the housing. Remove the gasket from the lens. Refer to *Section 9, Exploded Views and Replacement Parts*.
- c. Loosen the Phillips head screw on the band clamp to allow the clamp to be removed. Screw should be loosened, but not removed to prevent loss of parts and ease of assembly
- d. Remove the band clamp, bezel face ring, glass lens, and gasket from the housing. Remove the gasket from the lens. Refer to *Section 9, Exploded Views and Replacement Parts*.
- e. Remove the two Phillips hex head Dichroic Lens holder Plate retaining screws.
- f. Carefully remove the Dichroic Lens Plate. The eight bulbs can now be removed. Discard the bulbs.
- g. Install eight new bulbs (four (4) sets of P/N R0399600 for **Jandy Pool Light** or four (4) sets of P/N R0400300 for **Jandy Spa Light**). Do not touch the bulb surface with bare hands, as this can dramatically reduce bulb life. Repeat procedure for each bulb.
- h. Re-position the Lens Plate over the bulbs.
- i. Install the two Lens Plate retaining screws. Do not over-tighten.

**⚠ WARNING**

**Risk of Electrical Shock or Electrocution.** Always install a new lens gasket whenever disassembling the light (for **Jandy Pool Light Gasket** P/N R0399800 and for **Jandy Spa Light Gasket** P/N R0400500). Failure to do so may permit water to leak into the assembly, which could cause:

- (a) An electrical hazard resulting in death or serious injury to pool or spa users, installers, or others due to electrical shock, or
- (b) Breakage of the bulb or lens, which likewise could result in serious injury to pool or spa users, installers, or bystanders, or in damage to property.

5. Reassemble the fixture (applies to both **Jandy Pool Light** and **Jandy Spa Light**).
  - a. If not already done, remove the gasket from the glass lens and install a new gasket, **Jandy Pool Light Gasket** (P/N R0399800) and **Jandy Spa Light Gasket** (P/N R0400500), on the lens.

**NOTE** A new lens gasket must be used each time the light is reassembled.

- b. While holding the fixture upright, place the glass lens with gasket and bezel face ring with the on top of the light shell. Align the pilot screw in the bezel face ring with the arrow located on the housing label marked “Arrow on this label must line up with the pilot screw on the face ring”. Make sure lens is properly aligned as well, with the letter “O” in Top aligned directly with the bezel face ring pilot screw and the can label previously described.
- c. While holding the aligned face ring and shell together turn the assembly upside down and set it on the old gasket, using the old gasket as an assembly fixture. This will keep the lens and gasket assembly from being pushed out of the face ring while you secure it to the light fixture.

For Pool Light Assembly do Steps d and e, and for Spa Light removal do Steps f and g. Then continue with Step h.

- d. Install the lower clamp, bezel face ring including the upper clamp, glass lens and new gasket on top of the housing. Spread the bottom clamp over the electrical cord and slide up to the back side of the bezel, using the bumps to align. Refer to *Section 9, Exploded Views and Replacement Parts*.
  - e. Tighten eight (8) Phillips head screws on the bottom clamp to the bezel clamp assembly, tightening the screws in alternating cross-pattern. Torque screws to approximately 32 in-lbs.
  - f. With the clamp bolt flange pointing to the side, spread the clamp and place it around the face ring, gasket and housing flange as shown in the exploded view in *Section 9*. Check to see that the clamp is properly installed around the entire flange. It is important to have the screw already started in the clamp retaining swivel nut as it makes installation much easier.
  - g. In the event the clamp screw is not already in the clamp retaining swivel nut, hold the ends of the clamp together. Insert the bolt through the open side and thread it into the round swivel nut. Using a Phillips head screwdriver, tighten the screw until the distance between the ends of the clamp equals  $\frac{1}{4}$  inch or less.
  - h. Discard the old gasket.
6. Reinstall the Jandy Light into niche fixture.
    - a. Coil the extra cord around the fixture and place the light assembly into the niche.
    - b. Engage the retainer tab on the bottom of the face ring, then pivot the top of the fixture inward and tighten the special pilot screw.

 **WARNING**

Use only the special pilot screw provided with this underwater light. This screw mounts and electrically grounds the housing securely to the mounting ring and wet niche. Failure to use the screw provided could create an electrical hazard, which could result in death or serious injury to pool or spa users, installers or others due to electrical shock.



7. If pool or spa is empty, fill pool or spa until the underwater light is completely submerged in water before operating the light for more than 10 seconds. Turn on main switch or circuit breaker, as well as the switch, which specifically operates the underwater light, to check for proper operation.

**⚠ WARNING**

Never operate this underwater light for more than 10 seconds unless it is totally submerged in water. Without total submersion, the light assembly will get extremely hot, which may result in serious burns or in breakage of the bulb or lens. This may result in serious injury to pool or spa users, installers, or bystanders or in damage to property.

## Section 8. Twelve (12) Volt Installation

A separate 12-Volt AC Transformer is required on all 12-Volt Models--For **Jandy Pool Light** use a 300-watt multi tap 12-volt system. For the **Jandy Spa Light**, a 100 watt 12-volt system is acceptable. To ensure maximum safety, it is strongly recommended that a transformer that has been listed or recognized by a Nationally Recognized Testing Laboratory (NRTL) for the application be used.

**NOTE** Jandy does not recommend installing 12-volt lights with cord lengths greater than 50 feet. A significant voltage drop will occur that dramatically reduces the light output and possibly unit failure. Wires from Transformer to Junction Box can reduce voltage and brilliance in addition to losses in the 12 gauge 12-volt cord. Refer to chart below for wire voltage losses and potential effect.

12 Gauge Cord Length	12 Volt		13 Volt		14 Volt	
	Volt @ Light	Change in Output	Volt @ Light	Change in Output	Volt @ Light	Change in Output
50ft	10.18V	0%	11.10V	0%	12.01V	0%
75ft	9.40V	15%	10.27V	0%	11.14V	0%
100ft	Not Recommended		9.50V	0%	10.34V	0%

**SAVE THESE INSTRUCTIONS**

## Section 9. Exploded View and Replacement Parts

### 9.1 Jandy Digital Pool Light

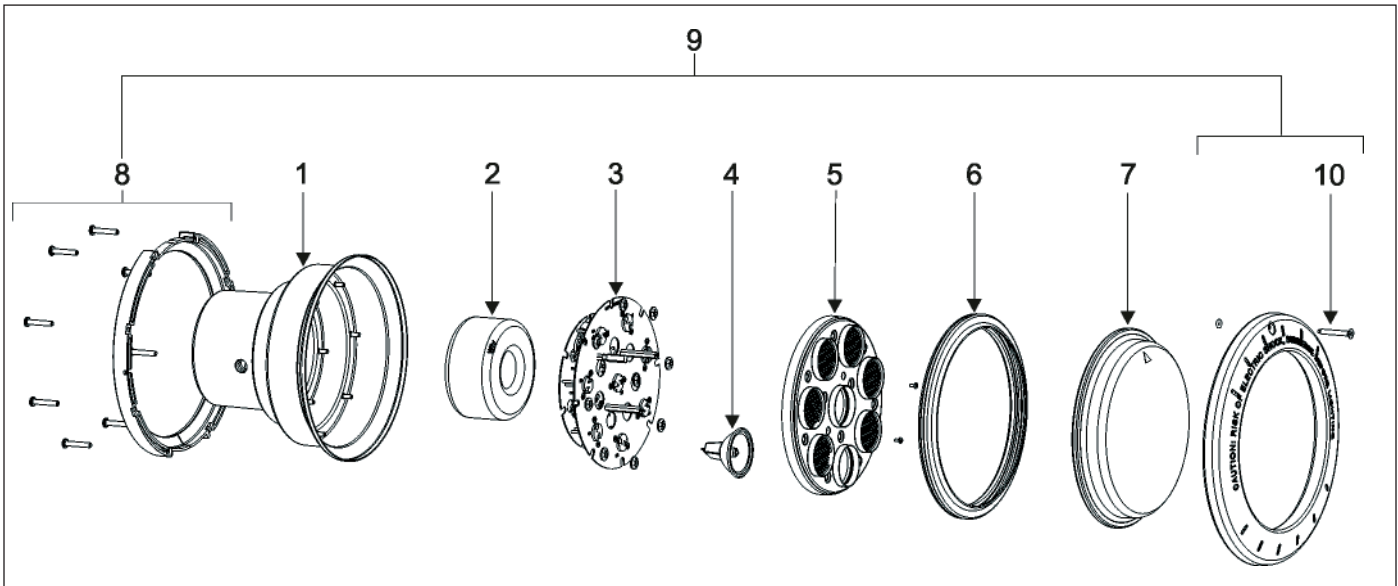

Figure 7. Jandy Digital Pool Light Exploded View

DWG#	Part#	Description	Field Replaceable
1	N/A	Pool Light Housing	NO - Purchase New Light
2	N/A	Transformer (120 Volt lights only)-Pool	NO - Purchase New Light
3	N/A	Bulb Holder and Electronics Assembly-Pool	NO - Purchase New Light
4	R0399600	Bulb Kit: 75 Watt Halogen MR-16 EYC (2 bulbs in kit, 8 bulbs required per light)	YES
5	R0399700	Dichroic Lens Holder Assembly-Pool	YES
6	R0399800	Silicone Gasket-Pool	YES
7	R0399900	Glass Lens-Pool	YES
8	R0400000	Bottom Clamp -Pool	YES
9	R0400100	Bezel Clamp Assembly- Pool	YES
10	R0400200	Pilot Screw with Captive Washer Assembly-Pool	YES

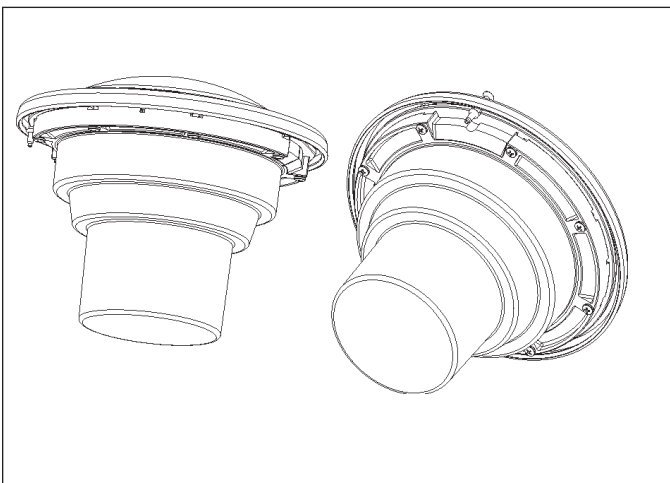

Figure 8. Three Dimensional View from Back Side

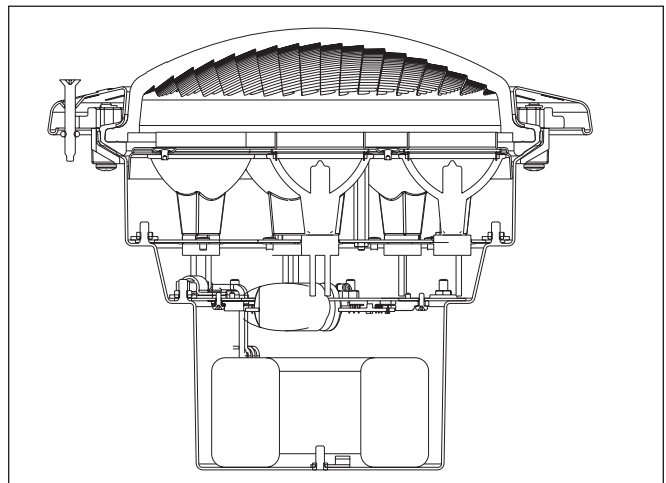

Figure 9. Cross Section of Jandy Pool Light

9.2 Jandy Digital Spa Light

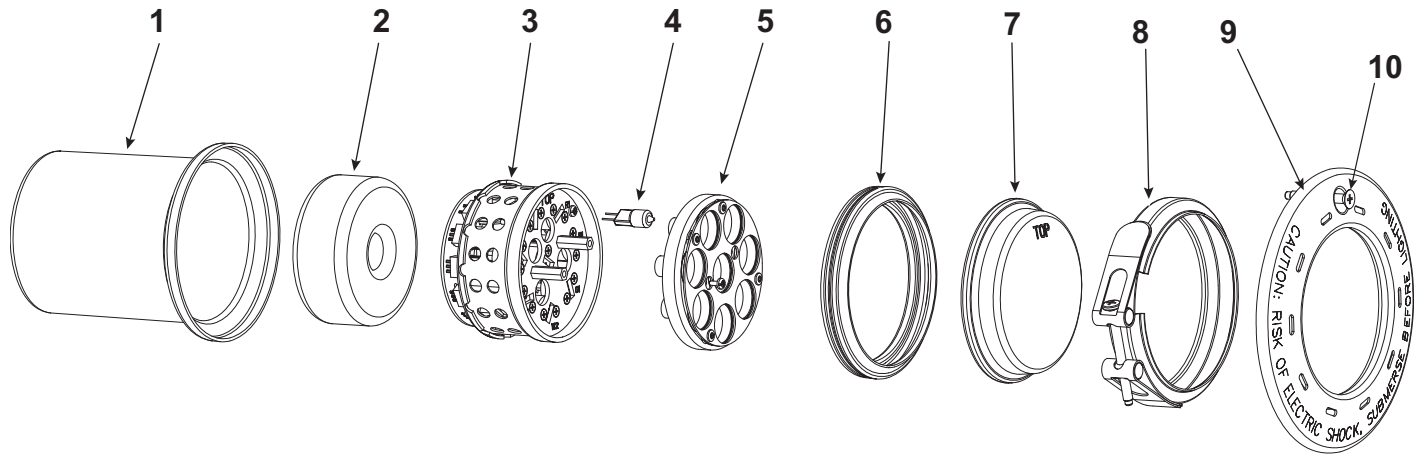

Figure 10. Jandy Digital Spa Light Exploded View

DWG#	Part#	Description	Field Replaceable
1	N/A	Spa Light Housing	NO - Purchase New Light
2	N/A	Transformer (120 Volt lights only)-Spa	NO - Purchase New Light
3	N/A	Bulb Holder and Electronics Assembly-Spa	NO - Purchase New Light
4	R0400300	Bulb Kit: 25 Watt Halogen, G-4 Capsule, 12 Volt AC (2 bulbs per kit, 8 bulbs required per light)	YES
5	R0400400	Dichroic Lens Holder Assembly-Spa	YES
6	R0400500	Silicon Gasket-Spa	YES
7	R0400600	Glass Lens-Spa	YES
8	R0400700	Clamp Assembly-Spa	YES
9	R0400800	Bezel Assembly-Spa	YES
10	R0400900	Pilot Screw with Captive Washer Assembly-Spa	YES

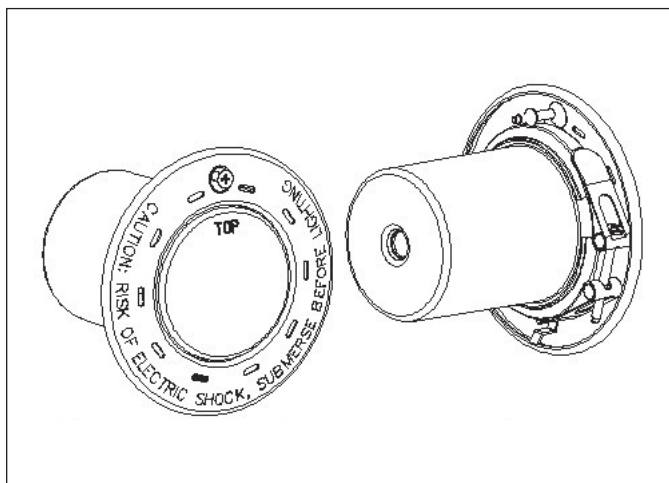

Figure 11. Three Dimensional View, Front and Back

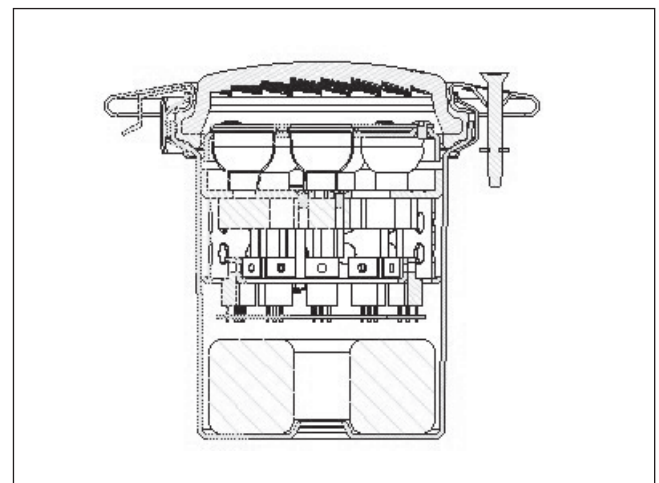

Figure 12. Cross Section of Jandy Spa Light

## LIMITED WARRANTY

Thank you for purchasing Jandy® pool and spa products. Jandy Pool Products, Inc. warrants all parts to be free from manufacturing defects in materials and workmanship for a period of one year from the date of retail purchase, with the following exceptions:

- AquaLink® RS units installed with Jandy Surge Protection Kits will be covered for two years.
- NeverLube® valves are warranted for the life of pool and/or spa on which they were originally installed.
- AquaPure™ Electronic Chlorine Generator Electrolytic Cells carry a 5 year limited warranty on a prorated basis.

This warranty is limited to the first retail purchaser, is not transferable, and does not apply to products that have been moved from their original installation sites. The liability of Jandy Pool Products, Inc. shall not exceed the repair or replacement of defective parts and does not include any costs for labor to remove and reinstall the defective part, transportation to or from the factory, and any other materials required to make the repair. This warranty does not cover failures or malfunctions resulting from the following:

1. Failure to properly install, operate or maintain the product(s) in accordance with our published Installation, Operation and Maintenance Manuals provided with the product(s).
2. The workmanship of any installer of the product(s).
3. Not maintaining a proper chemical balance in your pool and/or spa [pH level between 7.2 and 7.8, Total Alkalinity (TA) between 80 to 120 ppm, Total Dissolved Solids (TDS) less than 2000 not including salt ppm].
4. Abuse, alteration, accident, fire, flood, lightning, rodents, insects, negligence or acts of God.
5. Scaling, freezing, or other conditions causing inadequate water circulation.
6. Operating the product(s) at water flow rates outside the published minimum and maximum specifications.
7. Use of non-factory authorized parts or accessories in conjunction with the product(s).
8. Chemical contamination of combustion air or improper use of sanitizing chemicals, such as introducing sanitizing chemicals upstream of the heater and cleaner hose or through the skimmer.
9. Overheating; incorrect wire runs; improper electrical supply; collateral damage caused by failure of O-Rings, DE grids, or cartridge elements; or damage caused by running the pump with insufficient quantities of water.

### LIMITATION OF LIABILITY:

This is the only warranty given by Jandy Pool Products, Inc. No one is authorized to make any other warranties on behalf of Jandy Pool Products, Inc. **THIS WARRANTY IS IN LIEU OF ALL OTHER WARRANTIES, EXPRESSED OR IMPLIED, INCLUDING BUT NOT LIMITED TO ANY IMPLIED WARRANTIES OF FITNESS FOR A PARTICULAR PURPOSE AND MERCHANTABILITY. JANDY POOL PRODUCTS, INC. EXPRESSLY DISCLAIMS AND EXCLUDES ANY LIABILITY FOR CONSEQUENTIAL, INCIDENTAL, INDIRECT OR PUNITIVE DAMAGES FOR BREACH OF ANY EXPRESSED OR IMPLIED WARRANTY.** This warranty gives you specific legal rights. You may also have other rights which vary by state or province.

### WARRANTY CLAIMS:

For prompt warranty consideration, contact your dealer and provide the following information: proof of purchase, model number, serial number and date of installation. The installer will contact the factory for instructions regarding the claim and to determine the location of the nearest designated service center. If the dealer is not available, you can locate a service center in your area by visiting [www.jandy.com](http://www.jandy.com) or by calling our technical support department at (707) 776-8200 extension 260. All returned parts must have a Returned Material Authorization number to be evaluated under the terms of this warranty.

H0561200C



ETL LISTED  
CONFORMS TO  
UL STD 676

6000 Condor Drive, Moorpark, CA, USA 93021 • 707.776.8200 FAX 707.763.7785

Litho in U.S.A. © 2006 Jandy Pool Products, Inc. 0602

For technical support call 707-776-8200, ext. 260